

99342 Series

Counter Top Pastry Merchandiser



Features & Finishes:

- Anodized Aluminum Frame
- Tempered Glass Ends
- Aluminum Framed Tempered Glass, Hinged Doors (Self-Closing)
- Solid Back
- (4) Tier of Aluminum Pan Supports on Standards w/ Adjustable (Level to Slant) Brackets
- Adjustable Bag Bin(s) 4 1/2" H
- 2-Vertical Side Lights
- Air Vents (2)
- White LPL Exterior Finish
- White HPL Interior Deck
- White Interior
- 12" Cord, Plug and Switch
- U.L. Listed



SPARTAN SHOWCASE IS A
DIVISION OF PROCK OPERATIONS™

sales@spartanshowcase.com
Phone: 800.325.0775
Fax: 573.265.5124



99342 Series

Counter Top Pastry Merchandiser

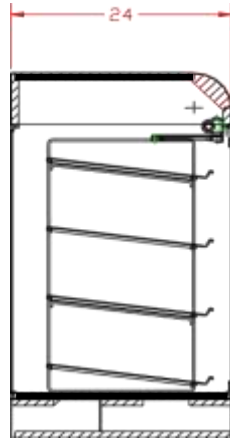

END SECTION

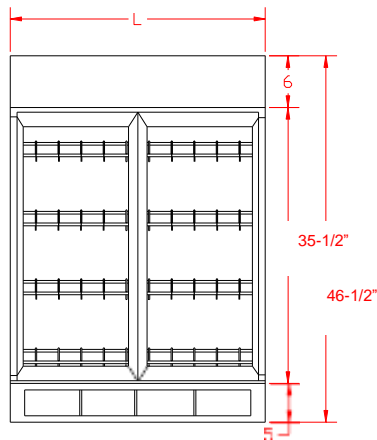
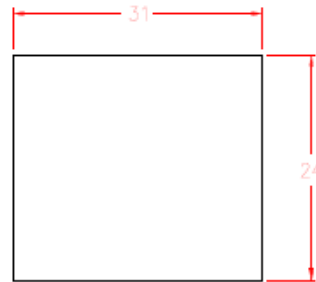

FRONT ELEVATION



REAR ELEVATION

Model No.	Dimensions L X D X H	Rows of Shelves	Pan Capacity Full – 18"x26" Half – 13"x18"	Est. Crated Weight	Options / Accessories to Customize Case
99342-31	31" x 24" x 46-1/2"	4	4 - Full	245 lbs.	<ol style="list-style-type: none"> 1. "ETL" Sanitation Listed (Conforms to NSF STD-2) 2. Standard HPL Exterior 3. Standards & Brackets for Fully Adj. Height Shelves 4. Mirror Ends 5. Mirror Back 6. Top Light T-8 Fluorescent 8. LED vs. T-8 Fluorescent Bulbs 9. Bottom Mount Cord & Plug with Interior Light Switch 10. Powder Coat Finishes Available for Frame, Hardware, & Shelves

SPARTAN SHOWCASE IS A
DIVISION OF PROCK OPERATIONS™

sales@spartanshowcase.com
Phone: 800.325.0775
Fax: 573.265.5124

