

# 96000 Series Slant-Front Display Case



## Features & Finishes

- Anodized Aluminum Frame
- Tempered Glass Front, Ends, & Top
- Aluminum Framed, Sliding Tempered Glass Doors
- Tempered Glass Shelves (38" H-2) (48" H-3)
- White LPL Finish
- White HPL Deck
- White Interior Storage
- Open Rear Storage
- 4 1/2"H Black Kick
- Top Light with T-8 Safety Coated Bulbs
- 12" Cord, Plug & Switch
- U.L. #65 Wired Cabinet Listed



SPARTAN SHOWCASE IS A  
DIVISION OF PROCK OPERATIONS™

[sales@spartanshowcase.com](mailto:sales@spartanshowcase.com)  
Phone: 800.325.0775  
Fax: 573.265.5124



# 96000 Series Slant-Front Display Case

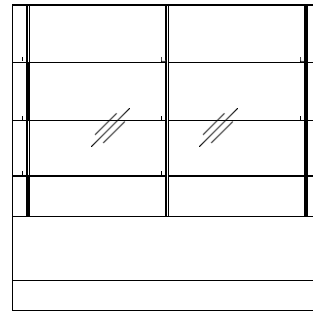
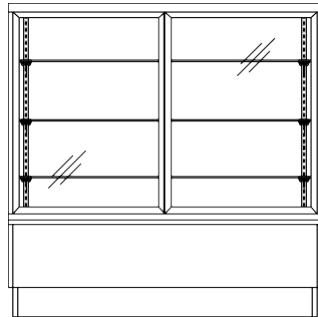
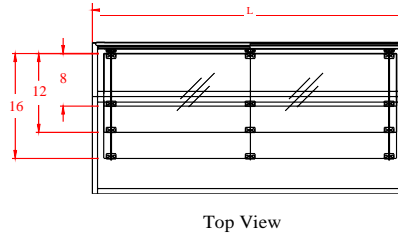
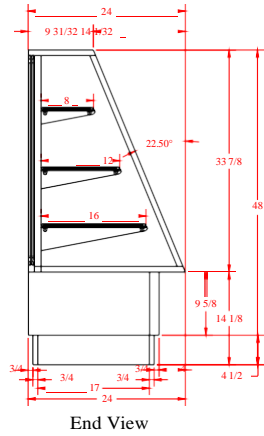

Model No.	Dimensions: L x D x W	Rows of Shelves	Est. Crated Weight	Options / Accessories to Customize Case
96048-48	48" x 24" x 48"	3	418 lbs.	1. Std. HPL Finish Base 2. Mirror Doors 3. Mirror Ends 4. Shelf Lights with T-8 Safety Coated Bulbs 5. LED Lights
96048-59	59" x 24" x 48"	3	440 lbs.	
96048-77	77" x 24" x 48"	3	525 lbs.	

Specifications Subject to Change Without Notice



SPARTAN SHOWCASE IS A  
DIVISION OF PROCK OPERATIONS™

sales@spartanshowcase.com  
Phone: 800.325.0775  
Fax: 573.265.5124

