

97000 Series

Straight Front High Volume Non-Refrigerated Display Cases (Tilt-Front)



Features & Finishes:

- Removable Tempered Glass Front Panels for Ease in Cleaning
- Anodized Aluminum Frame
- Tempered Glass Front, & Ends
- Top Light & Removeable Shelf Lights with T-8 Safety Coated Bulbs
- Aluminum Framed Manual Sliding Tempered Glass Doors
- White Wire Shelves, Level Brackets
(40" Ht. – 2 Tiers) (48" Ht. – 3 Tiers)
- Open Rear Storage - White Interior
- White HPL Deck
- Black HPL Base
- 12" Cord, Plug & Switch
- U.L. #65 Wired Cabinet Listed



SPARTAN SHOWCASE IS A
DIVISION OF PROCK OPERATIONS™

sales@spartanshowcase.com
Phone: 800.325.0775
Fax: 573.265.5124



97000

Straight Front High Volume Non-Refrigerated Display Cases (Tilt-Front)

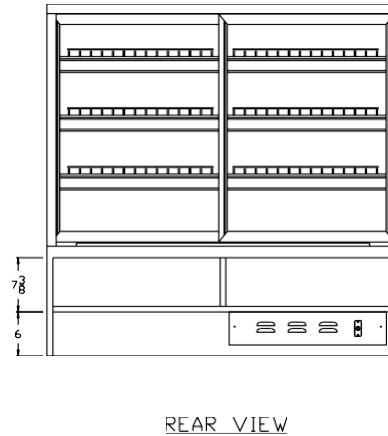
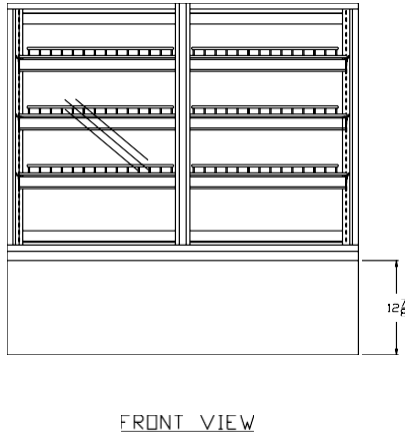
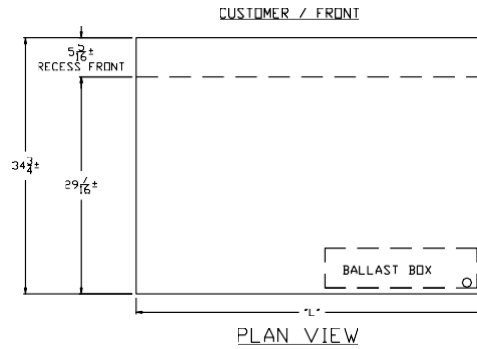
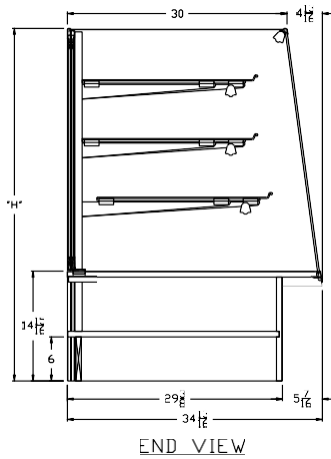

Model No.	Dimensions L X W X H	Rows Of Shelves	Pan Capacity	Est. Crated Weight	Options / Accessories to Customize the Case
97040-48	48" X 34 13/16" X 40"	2	6 Full/3 Half	460 lbs.	1. "ETL" Sanitation Listed (Conforms to NSF STD-2)
97040-59	59" X 34 13/16" X 40"	2	9 Full	480 lbs.	2. Powder Coat Finishes Available for Frame, Hardware, Lights, & Shelves
97040-77	77" X 34 13/16" X 40"	2	12 Full	595 lbs.	3. Standard HPL Exterior Finish
					4. Transparent Mirror Doors
97048-48	48" X 34 13/16" X 48"	3	8 Full/4 Half	500 lbs.	5. Mirror Doors with White HPL Exterior
97048-59	59" X 34 13/16" X 48"	3	12 Full	540 lbs.	6. Vented Doors
97048-77	77" X 34 13/16" X 48"	3	16 Full	640 lbs.	7. Mirror Ends
					8. Package Ledge Below Rear Doors
					9. Casters or Legs (Adds 7-1/2" to Total Heights)
					10. LED Lights

Specifications Subject to Change Without Notice

SPARTAN SHOWCASE IS A
DIVISION OF PROCK OPERATIONS™

sales@spartanshowcase.com
Phone: 800.325.0775
Fax: 573.265.5124

