

# 93000 Series

## Tilt-Out Curved Front High Volume Non-Refrigerated Display Cases



### Features & Finishes:

- Tilt-Out Curved Front Glass for Ease in Cleaning Glass
- White HPL Solid Top Work Surface
- Aluminum Framed, Manual Sliding, Mirror Doors
- Top Light & Removable Shelf Lights with T-8 Safety Coated Bulbs
- White HPL Exterior Finish
- White HPL Deck
- Mirror Ends
- White Wire Shelves, 7-1/2° Slant (40" Ht. – 2 Tiers) (48" Ht. – 3 Tiers)
- 12" Cord, Plug & Switch
- U.L. #65 Wired Cabinet Listed



SPARTAN SHOWCASE IS A  
DIVISION OF PROCK OPERATIONS™

[sales@spartanshowcase.com](mailto:sales@spartanshowcase.com)  
Phone: 800.325.0775  
Fax: 573.265.5124



# 93000 Series

## Tilt-Out Curved Front High Volume Non-Refrigerated Display Cases

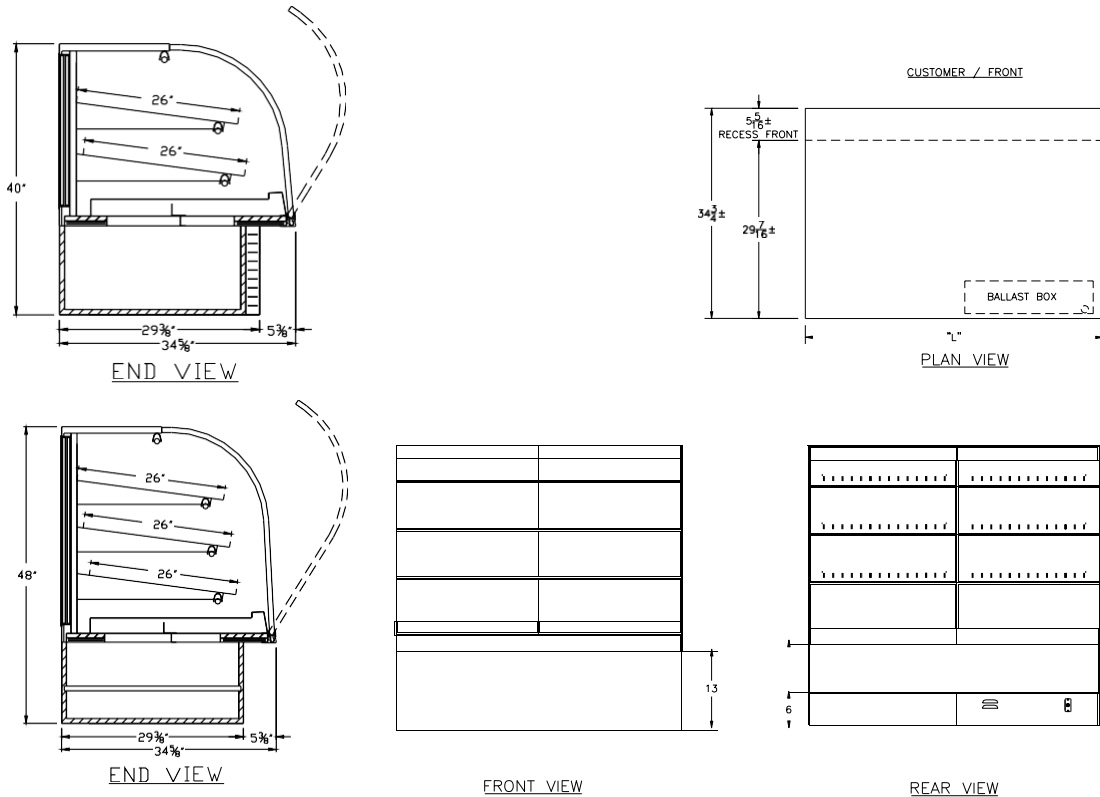

Model No.	Dimensions L X D X H	Rows of Shelves	Pan Capacity	Est. Crated Weight	Options / Accessories to Customize the Case
93040-48	48" x 34 3/4" x 40"	2	6 Full/3 Half	480 lbs.	1. "ETL" Sanitation Listed (Conforms to NSF STD-2) 2. Powder Coat Finishes Available for Frame, Hardware, Lights, & Shelves 3. Standard Exterior Finish 4. Transparent Mirror Doors 5. Vented Doors 6. Glass Doors 7. Package Ledge Below Rear Doors 8. Purse Ledge Below Curved Glass on Front 9. Casters or Legs (Adds 7 1/2" to Total Height) 10. LED Lights
93040-59	59 1/4" x 34 3/4" x 40"	2	9 Full	525 lbs.	
93040-77	77 1/4" x 34 3/4" x 40"	2	12 Full	610 lbs.	
93048-48	48" x 34 3/4" x 48"	3	8 Full/4 Half	540 lbs.	
93048-59	59 1/4" x 34 3/4" x 48"	3	12 Full	550 lbs.	
93048-77	77 1/4" x 34 3/4" x 48"	3	16 Full	635 lbs.	

Specifications Subject to Change Without Notice



SPARTAN SHOWCASE IS A  
DIVISION OF PROCK OPERATIONS™

sales@spartanshowcase.com  
Phone: 800.325.0775  
Fax: 573.265.5124

