

# F900 Series Extra View Showcases



## Standard Specifications:

- Two Split Tempered Glass Shelves (1-8" and 1-10") Adjustable
- Anodized Silver Satin Finish Aluminum Frame & Trim
- 1/4" Tempered Glass Top, Front, Ends
- Laminated Interior Decks & Panel Doors: TFM (White or Black)
- Black Kick

SPARTAN SHOWCASE IS A  
DIVISION OF PROCK OPERATIONS™

[sales@spartanshowcase.com](mailto:sales@spartanshowcase.com)  
Phone: 800.325.0775  
Fax: 573.265.5124



# F900 Series Extra View Showcases

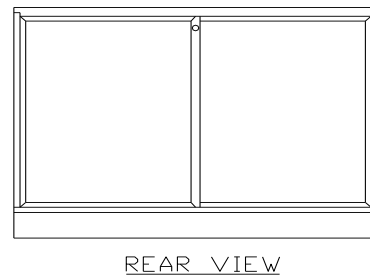
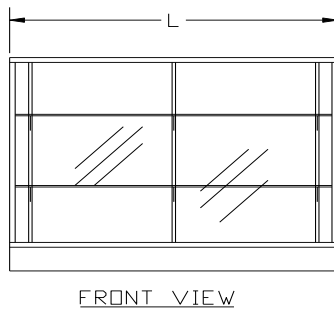
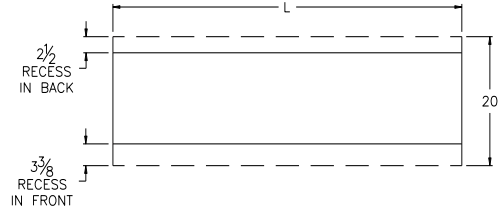
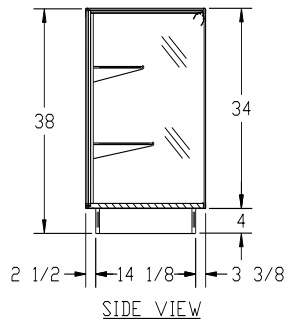

Model No.	Dimensions: L X D X H	Doors
F972	72" x 20" x 38"	Panel
F906	70" x 20" x 38"	Panel
F905	60" x 20" x 38"	Panel
F904	48" x 20" x 38"	Panel
F903	36" x 20" x 38"	Panel
F972A	72" x 20" x 38"	Mirror
F906A	70" x 20" x 38"	Mirror
F905A	60" x 20" x 38"	Mirror
F904A	48" x 20" x 38"	Mirror
F903A	36" x 20" x 38"	Mirror

## Case Options:

- |                            |                               |
|----------------------------|-------------------------------|
| 1. Light                   | 6. Flush Front Kick           |
| 2. Door Lock               | 7. Clear Glass Doors          |
| 3. UL Listed Cabinet Label | 8. Powdercoat Finished Frames |
| 4. UL Listed Cord and Plug | 9. Custom Sizes               |
| 5. Mirror or Solid Ends    |                               |

SPARTAN SHOWCASE IS A  
DIVISION OF PROCK OPERATIONS™

sales@spartanshowcase.com  
Phone: 800.325.0775  
Fax: 573.265.5124

