

97000 Series Straight Front High Volume Non-Refrigerated Display Cases



Features & Finishes:

- Anodized Aluminum Frame
- Tempered Glass Front, Ends, & Tops
- Top Light & Removeable Shelf Lights with T-8 Safety Coated Bulbs
- Aluminum Framed Manual Sliding Tempered Glass Doors
- Metal Shelf Pan Supports on Standards w/ Adj. (Level to Slant) Brackets; (40" Ht. – 2 Tiers) (48" Ht. – 3 Tiers)
- Open Rear Storage - White Interior
- White HPL Deck
- Black HPL Base
- 12" Cord, Plug & Switch
- U.L. #65 Wired Cabinet Listed



SPARTAN SHOWCASE IS A
DIVISION OF PROCK OPERATIONS™

sales@spartanshowcase.com
Phone: 800.325.0775
Fax: 573.265.5124



97000 Series

Straight Front High Volume

Non-Refrigerated Display Cases

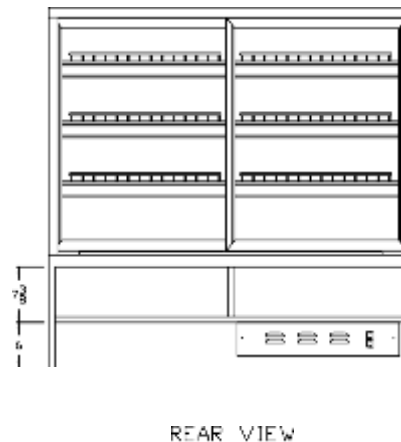
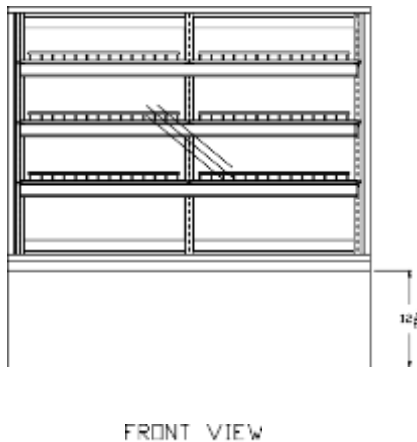
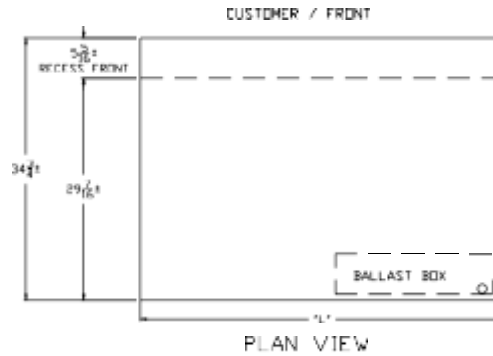
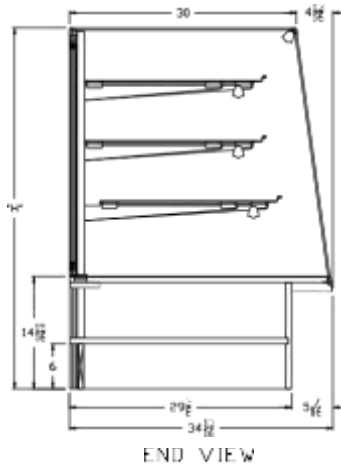

Model No.	Dimensions L X W X H	Rows Of Shelves	Pan Capacity	Est. Crated Weight	Options / Accessories to Customize the Case
97040-48	48" X 34 13/16" X 40"	2	6 Full/3 Half	460 lbs.	1. "ETL" Sanitation Listed (Conforms to NSF STD-2) 2. Powder Coat Finishes Available for Frame, Hardware, Lights, & Shelves 3. Standard HPL Exterior Finish 4. Transparent Mirror Doors 5. Mirror Doors with White HPL Exterior 6. Vented Doors 7. Mirror Ends 8. Package Ledge Below Rear Doors 9. Casters or Legs (Adds 7-1/2" to Total Heights) 10. LED Lights
97040-59	59" X 34 13/16" X 40"	2	9 Full	480 lbs.	
97040-77	77" X 34 13/16" X 40"	2	12 Full	595 lbs.	
97048-48	48" X 34 13/16" X 48"	3	8 Full/4 Half	500 lbs.	
97048-59	59" X 34 13/16" X 48"	3	12 Full	540 lbs.	
97048-77	77" X 34 13/16" X 48"	3	16 Full	640 lbs.	

Specifications Subject to Change Without Notice

SPARTAN SHOWCASE IS A
DIVISION OF PROCK OPERATIONS™

sales@spartanshowcase.com
Phone: 800.325.0775
Fax: 573.265.5124

