

# 99058 Series Self-Serve Wallcases



## Features & Finishes:

- Self-Closing Frameless Doors
- Continuous White Wire Shelves (4)
- Top & Under Shelf Lights with Lamps & Shields
- Solid Back
- Lower Front Panel
- Pullout Package Ledge with Tissue Compartment
- Adjustable Bag Bins
- White Interior
- White HPL Finish Front & Ends
- Radius Curve Top Fascia (6" High)
- 6" Black Kick Base
- Air Vents in Top (3)
- 12" Cord, Plug & Switch
- U.L. & C.U.L. Listed



SPARTAN SHOWCASE IS A  
DIVISION OF PROCK OPERATIONS™

[sales@spartanshowcase.com](mailto:sales@spartanshowcase.com)  
Phone: 800.325.0775  
Fax: 573.265.5124



# 99058 Series Self-Serve Wallcases

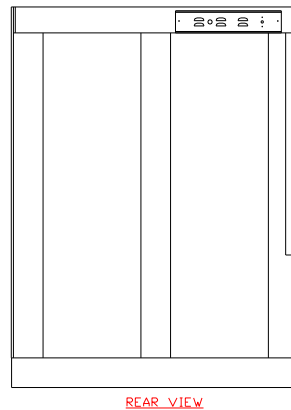
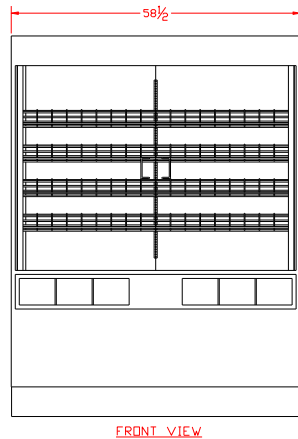
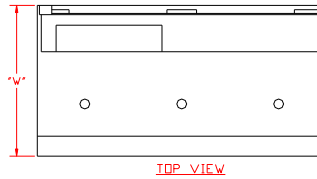
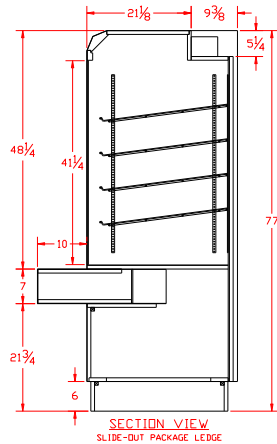

Model No.	Dimensions: L X W X H	Rows of Shelves	Est. Crated Weight	No. of Pan Capacity	Case Options:
99058	58 1/2" X 30 1/2" X 77"	4	710 lbs.	15	1. "ETL" Sanitation Listed (Conforms to NSF STD-2) 2. Mirror Ends 3. Mirror Back 4. Lower Front Storage Doors 5. Adjustable Wood Shelf (Storage Area)
99058RL	58 1/2" X 32 1/2" X 77" <i>RL = (Rear Load Mirror Doors)</i>	4	740 lbs.	15	

Specifications Subject to change without notice

SPARTAN SHOWCASE IS A  
DIVISION OF PROCK OPERATIONS™

sales@spartanshowcase.com  
Phone: 800.325.0775  
Fax: 573.265.5124

