

93000 Series

Tilt-Out Curved Front High Volume Non-Refrigerated Display Cases



Features & Finishes:

- Tilt-Out Curved Front Glass
- Solid Top Work Surface
- Aluminum Framed, Sliding, Mirror Doors
- Top Light & Shelf Lights with Lamps & Shields
- White HPL Deck
- White Wire Shelves, 7-1/2° Slanted (40"H-2)(48"H-3)
- Mirror Ends
- White HPL Exterior Finish
- 12" Cord, Plug & Switch
- U.L. & C.U.L. Listed



SPARTAN SHOWCASE IS A
DIVISION OF PROCK OPERATIONS™

sales@spartanshowcase.com
Phone: 800.325.0775
Fax: 573.265.5124



93000 Series

Tilt-Out Curved Front High Volume Non-Refrigerated Display Cases

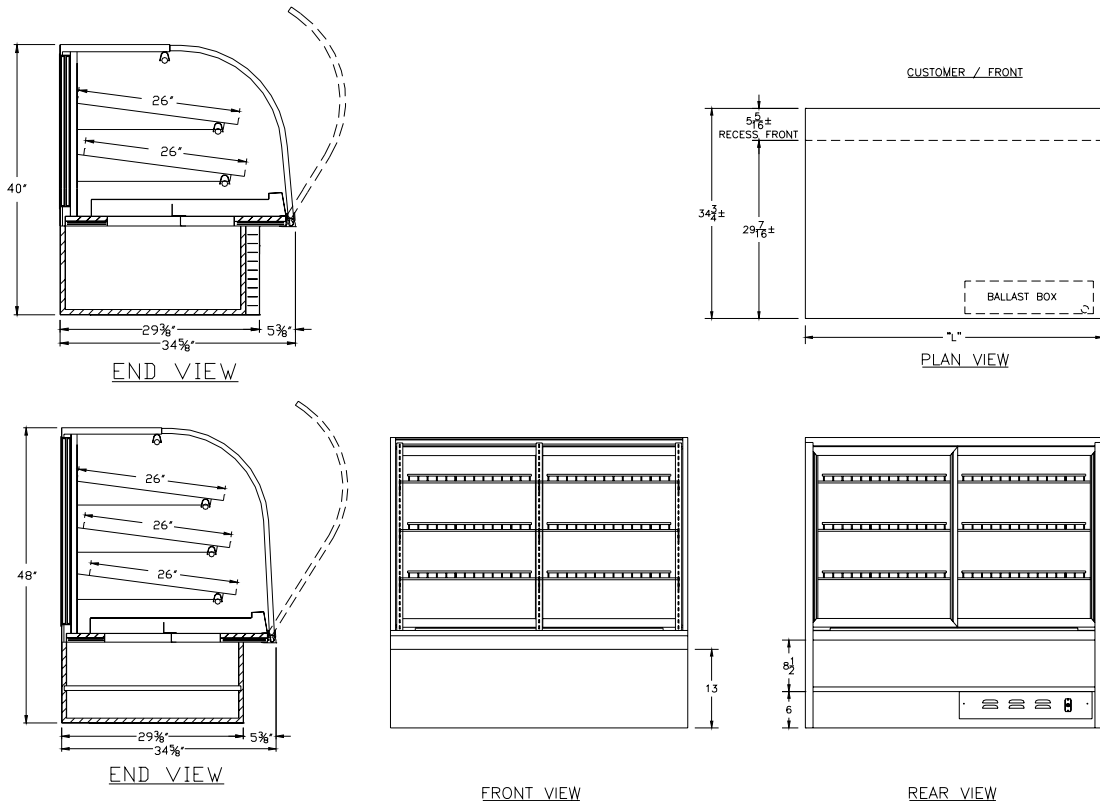

Model No.	Dimensions: L X D X H	Rows of Shelves	Pan Capacity	Est. Crated Weight	Case Options:
93040-48	48" x 34 3/4" x 40"	2	6 Full/3 Half	480 lbs.	1. "ETL" Sanitation Listed (Non-Tilting Front) (Conforms to NSF STD-2) 2. Brasstone or Black Finishes (Frame, Hardware, Lights & Shelves) 3. Brasstone or Black Finishes (Frame & Lights Only) 4. Transparent Mirror Doors 5. Vented Doors 6. Std. Exterior Finish 7. Package Ledge 8. Glass Doors 9. Remote Compressor (Shipped Separately) 10. Casters or Legs (Adds 7 1/2" to Total Height)
93040-59	59 1/4" x 34 3/4" x 40"	2	9 Full	525 lbs.	
93040-77	77 1/4" x 34 3/4" x 40"	2	12 Full	610 lbs.	
93048-48	48" x 34 3/4" x 48"	3	8 Full/4 Half	540 lbs.	
93048-59	59 1/4" x 34 3/4" x 48"	3	12 Full	550 lbs.	
93048-77	77 1/4" x 34 3/4" x 48"	3	16 Full	635 lbs.	

Specifications Subject to change without notice



SPARTAN SHOWCASE IS A
DIVISION OF PROCK OPERATIONS™

sales@spartanshowcase.com
Phone: 800.325.0775
Fax: 573.265.5124

