

# F900 Series

## Extra View Showcases



### Standard Specifications:

- Two Split Glass Shelves (1-8" and 1-10")
- Anodized Silver Satin Finish Aluminum Frame & Trim
- 1/4" Annealed Float Glass Top, Front, Ends & Shelves
- Glass Shelves are Adjustable
- Laminated Interior Decks & Panel Doors: Low Pressure Laminate (LPL) Beige, White, Grey or Black
- Black Kick

P. O. BOX 470  
Union, MO 63084

Phone: 1.800.325.0775  
Fax: 1.636.583.4067

# F900 Series

## Extra View Showcases

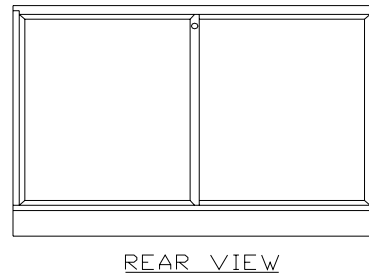
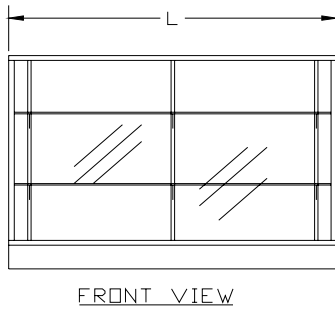
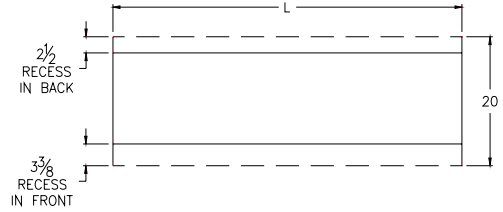
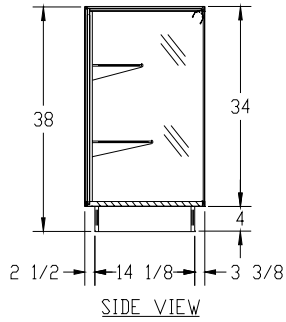

Model No.	Dimensions: L X D X H	Doors
F972	72" x 20" x 38"	Panel
F906	70" x 20" x 38"	Panel
F905	60" x 20" x 38"	Panel
F904	48" x 20" x 38"	Panel
F903	36" x 20" x 38"	Panel
F972A	72" x 20" x 38"	Mirror
F906A	70" x 20" x 38"	Mirror
F905A	60" x 20" x 38"	Mirror
F904A	48" x 20" x 38"	Mirror
F903A	36" x 20" x 38"	Mirror

Case Options:	
<ul style="list-style-type: none"> <li>1. Light</li> <li>2. Door Lock</li> <li>3. UL Listed Cabinet Label</li> <li>4. UL Listed Cord and Plug</li> <li>5. Mirror or Solid Ends</li> </ul>	<ul style="list-style-type: none"> <li>6. Flush Front Kick</li> <li>7. Clear Glass Doors</li> <li>8. Gold, Brasstone, or Powdercoat Finished Frames</li> <li>9. Custom Sizes</li> </ul>

P. O. BOX 470  
Union, MO 63084

Phone: 1.800.325.0775  
Fax: 1.636.583.4067