

# 98100 Series

## Service Wallcases Full View



### Features & Finishes:

- Anodized Aluminum Trim
- Aluminum Framed Top Hung Sliding Glass Doors
- White Wire Shelves (7)
- Unfinished Exterior Back
- White HPL Interior Deck
- White Interior
- White HPL Finish Front & Ends
- Side Lights with Lamps & Shields
- 12" Cord, Plug, & Switch
- U.L. & C.U.L. Listed



P. O. BOX 470  
Union, MO 63084

Phone: 1.800.325.0775  
Fax: 1.636.583.4067

# 98100 Series

## Service Wallcases Full View

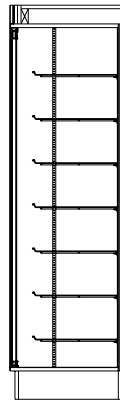

Side View

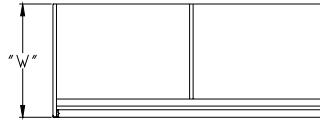

Top View

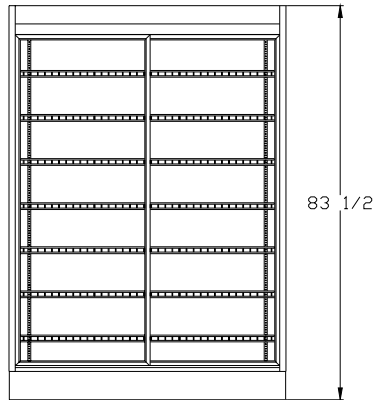

Front View

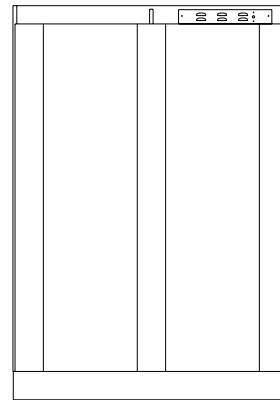

Rear View

Model No.	Dimensions: L X W X H	Rows of Shelves	Est. Crated Weight	NO. of Pan Capacity	Case Options:
98160-24	58 1/2" X 24" X 83 1/2"	7	595 lbs.	16	1. Extra Row Wire Shelf 2. Top Light 3. Shelf Lights
98162-30	62 1/8" X 30" X 83 1/2"	7	660 lbs.	24	
98180-30	80 1/8" X 30" X 83 1/2"	7	780 lbs.	32	

Specifications Subject to change without notice



P. O. BOX 470  
Union, MO 63084

Phone: 1.800.325.0775  
Fax: 1.636.583.4067