

97000-R Series

Mini Non-Refrigerated Display Cases

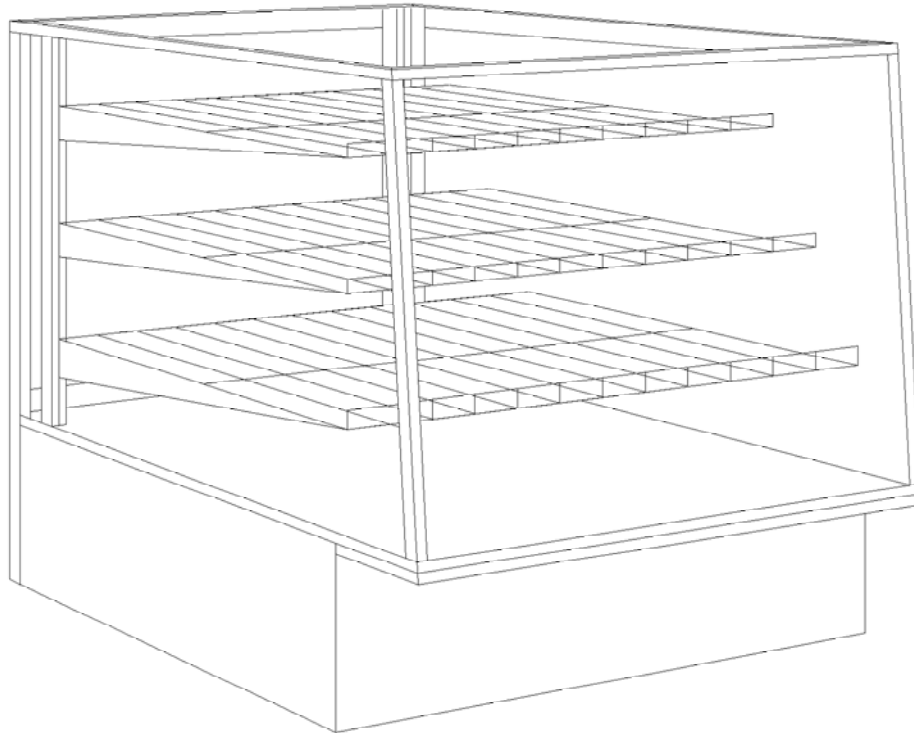

Features & Finishes:

- Anodized Aluminum Frame
- Tempered Glass Front
- Glass Ends & Tops
- Top Light with Lamp & Shield
- Aluminum Framed Sliding Glass Doors (Hinged Door 31" Long)
- White Wire Shelves (40"H - 2)(48"H - 3)
- Open Rear Storage - White Interior
- White HPL Deck
- Black HPL Base
- 12" Cord, Plug & Switch
- U.L. & C.U.L. Listed



321 E. Hardy St.
St. James, MO 65559

Phone: 1.800.356.8351
Fax: 1.573.265.5124

97000-R Series

Mini Non-Refrigerated Display Cases

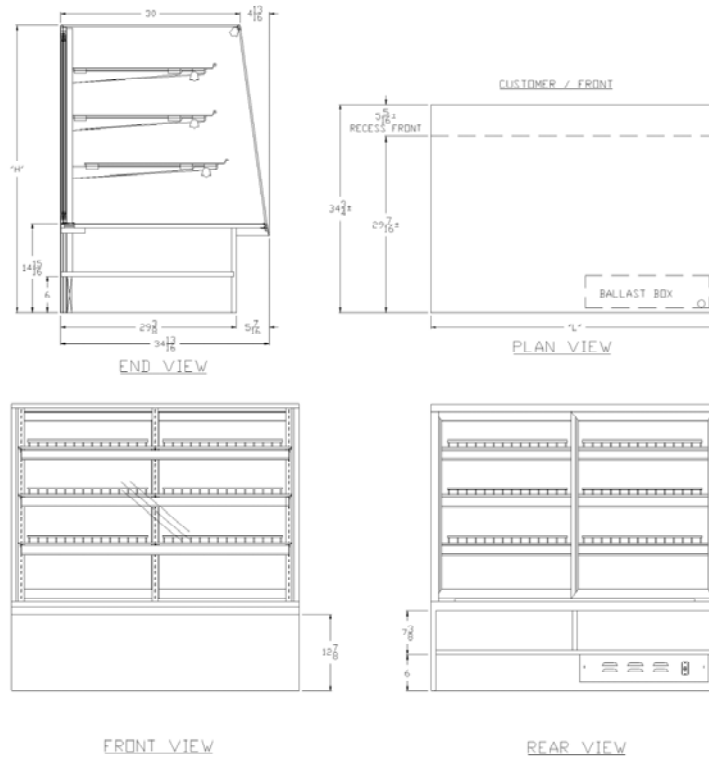

Model No.	Dimensions: L X D X H	Rows of Shelves	Est. Crated Weight	Case Options:
97040-36	36" X 34 13/16" X 40"	2	310 lbs.	<ol style="list-style-type: none"> 1. "ETL" Sanitation Listed (Conforms to NSF STD-2) 2. Brassstone or Black Finishes (Frame & Light Only) 3. Mirror Doors 4. Self Closing Front Doors (31"L Gets Hinged)(36"L & 40"L Gets Sliding) 5. Vented Doors 6. Std. HPL Finish Base 7. Mirror Ends 8. Shelf Lights with Lamps and Shields 9. Casters or Legs (Adds 7 1/2" to Total Height)
97040-40	40" X 34 13/16" X 40"	2	320 lbs.	
LV97048-31	31" X 30" X 48"	2	310 lbs.	
97048-36	36" X 34 13/16" X 48"	3	320 lbs.	
97048-40	40" X 34 13/16" X 48"	3	330 lbs.	

Specifications Subject to change without notice



321 E. Hardy St.
St. James, MO 65559

Phone: 1.800.356.8351
Fax: 1.573.265.5124

Email: sales@spartanshowcase.com

www.spartanshowcase.com